

## Remaining Recording Time/Battery Power

You can check the remaining video recording time on the SD card as well as the remaining battery power.

1 Display the remaining recording time.

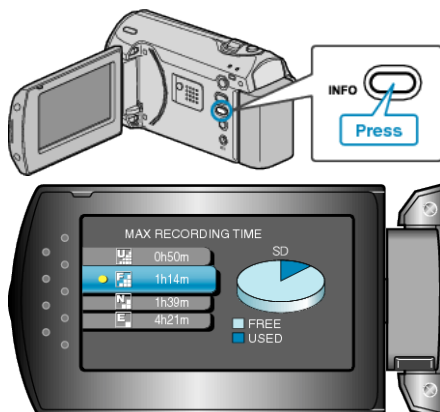

- While the remaining recording time is being displayed, press INFO to display the remaining battery power.
- To exit the display, press the MENU button.

2 Display the remaining battery power.

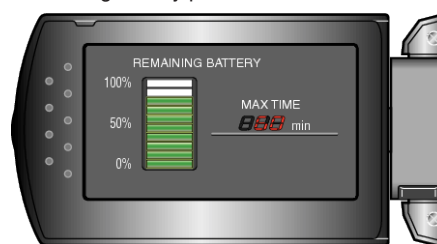

- To exit the display, press the INFO button.
- To display the remaining recording time again, press the MENU button.
- Remaining battery power will not be displayed when the AC adapter is connected.

### Memo:

- You can also change the video quality from the remaining recording time display. Select the video quality with the ZOOM/SELECT lever and press OK.

## Approximate Video Recording Time

Quality	SDHC Card 4 GB	SDHC Card 8 GB	SDHC Card 16 GB	SDHC Card 32 GB
ULTRA FINE	56 m	1 h 50 m	3 h 45 m	7 h 30 m
FINE	1 h 20 m	2 h 50 m	5 h 40 m	11 h 20 m
NORMAL	1 h 45 m	3 h 45 m	7 h 30 m	15 h
ECONOMY	4 h 57 m	10 h	20 h	40 h

- The actual recording time may shorten depending on the shooting environment.

## Approximate Recording Time (Using Battery)

Battery Pack	Actual Recording Time	Continuous Recording Time
BN-VG107U (Supplied)	50 m	1 h 30 m
BN-VG114U	1 h 40 m	3 h 5 m
BN-VG121U	2 h 35 m	4 h 40 m

- The above are values when "LCD BACKLIGHT" is set to "STANDARD".
- The actual recording time may be shorter if zooming is used or if recording is stopped repeatedly. (It is recommended to prepare battery packs ready for three times the expected recording time.)