

### Scene Selection

Common scenes that are often encountered can be recorded with the most suitable settings.

1 Press MENU to display the menu.

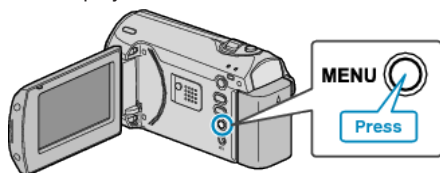

2 Select "MANUAL SETTING" with the ZOOM/SELECT lever and press OK.

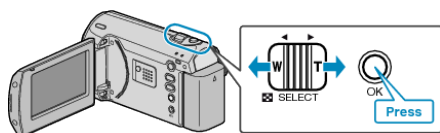

3 Select "SCENE SELECT" and press OK.

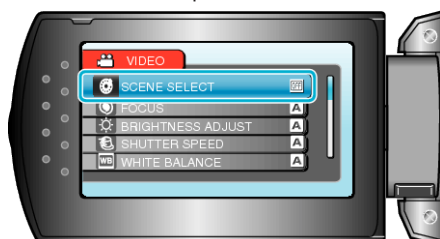

4 Select the scene and press OK.

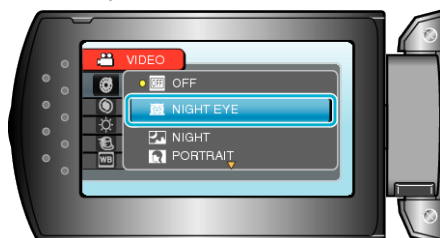

• After setting, press MENU.

\*The image is only an impression.

Setting	Effect
NIGHT EYE	Increases gain and brightens the scene automatically when the surrounding is dark. To prevent camera shake, use a tripod. <b>OFF</b> <b>ON</b>
NIGHT	Captures night scenes naturally. <b>OFF</b> <b>ON</b>
PORTRAIT	Blurs the background to bring out the people in the picture. <b>OFF</b> <b>ON</b>
SPORTS	Captures fast-moving subjects clearly in every single frame. <b>OFF</b> <b>ON</b>
SNOW	Prevents the subject from appearing too dark when recording snow scenes on a sunny day. <b>OFF</b> <b>ON</b>
SPOTLIGHT	Prevents the human subject from appearing too bright under light. <b>OFF</b> <b>ON</b>