

## Manual Recording

You can adjust settings, such as brightness and shutter speed, by using the manual mode.

1 Select the Manual recording mode.

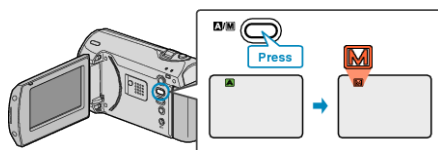

- The mode changes between Auto and Manual with every press.

2 Start recording.

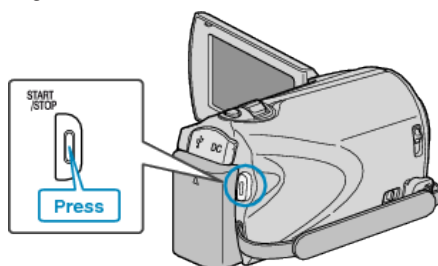

- Press again to stop.

### Memo:

- The manual settings are displayed only in the manual mode.

### Manual Recording Menu

The following items can be set.

Name	Description
SCENE SELECT	<ul style="list-style-type: none"> <li>• Recordings that suit the shooting conditions can be performed easily.</li> </ul>
FOCUS	<ul style="list-style-type: none"> <li>• Use manual focus if the subject is not focused automatically.</li> </ul>
BRIGHTNESS ADJUST	<ul style="list-style-type: none"> <li>• Overall brightness on the screen can be adjusted.</li> <li>• Use this when recording in a dark or bright location.</li> </ul>
SHUTTER SPEED	<ul style="list-style-type: none"> <li>• Shutter speed can be adjusted.</li> <li>• Use this when shooting a fast-moving subject or to emphasize the subject's movement.</li> </ul>
WHITE BALANCE	<ul style="list-style-type: none"> <li>• Overall color on the screen can be adjusted.</li> <li>• Use this when the color on the screen appears differently from the actual color.</li> </ul>
BACKLIGHT COMP.	<ul style="list-style-type: none"> <li>• Corrects the image when the subject appears dark due to backlight.</li> <li>• Use this when shooting against the light.</li> </ul>
METERING AREA/TYPE	<ul style="list-style-type: none"> <li>• Brightness of a specified area can be set as the standard.</li> </ul>
TELE MACRO	<ul style="list-style-type: none"> <li>• Use this to take close-up (macro) shots of the subject.</li> </ul>