

Inserting an SD Card (GZ-HM330)

When a commercially available SD card is inserted, recordings can still be made to the card without stopping when the remaining recording time on the internal memory runs out.

- 1 Press the power button for more than 2 seconds to turn off this unit.

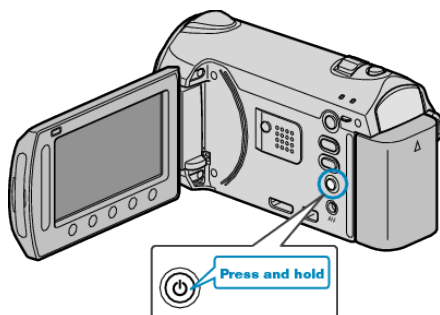

- 2 Open the card slot cover.

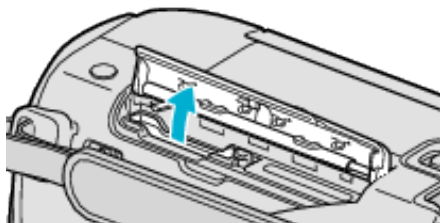

- 3 Insert an SD card.

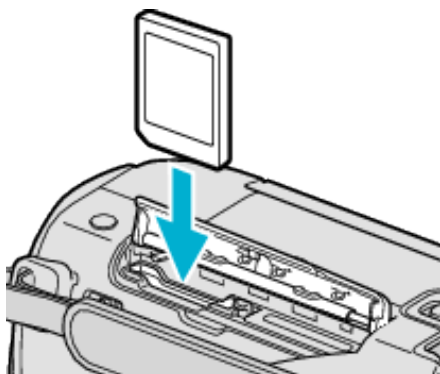

CAUTION:

- Make sure not to insert the card in the wrong direction. It may cause damage to the unit and card.
- Turn off the power of this unit before inserting or removing a card.

Memo:

- Recording switches automatically from one media to another and vice versa after the card or memory space in the selected media is full.
- To record to the card, it is necessary to adjust media settings. When no card is available, set media settings to "BUILT-IN MEMORY" for recording.
- To use cards that have been used on other devices, it is necessary to format (initialize) the card using "FORMAT SD CARD" from media settings.

Removing the Card

Push the card inward once, then pull it out straight.

