

Manual Recording

You can adjust settings, such as brightness and shutter speed, by using the manual mode.
Manual recording can be set for both video and still image modes.

1 Select video or still image mode.

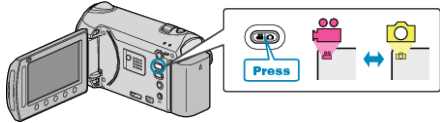

- The video or still image mode icon appears.

2 Select the Manual recording mode.

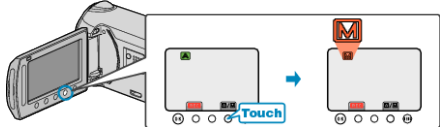

- The mode changes between Auto and Manual with every touch.

3 Start recording.

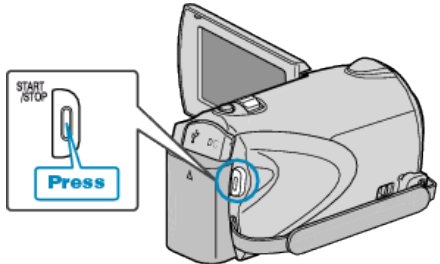

- Press again to stop.

Memo: _____
• The manual settings are displayed only in the manual mode.

Manual Recording Menu

The following items can be set.

Name	Description
SCENE SELECT	<ul style="list-style-type: none">• Recordings that suit the shooting conditions can be performed easily.
FOCUS	<ul style="list-style-type: none">• Use manual focus if the subject is not focused automatically.
FOCUS ASSIST	Focused subject is outlined in color for more precise focus.
BRIGHTNESS ADJUST	<ul style="list-style-type: none">• Overall brightness on the screen can be adjusted.• Use this when recording in a dark or bright location.
SHUTTER SPEED	<ul style="list-style-type: none">• Shutter speed can be adjusted.• Use this when shooting a fast-moving subject or to emphasize the subject's movement.
WHITE BALANCE	<ul style="list-style-type: none">• Overall color on the screen can be adjusted.• Use this when the color on the screen appears differently from the actual color.
BACKLIGHT COMP.	<ul style="list-style-type: none">• Corrects the image when the subject appears dark due to backlight.• Use this when shooting against the light.
METERING AREA/TYPE	<ul style="list-style-type: none">• Brightness of a specified area can be set as the standard.
EFFECT	<ul style="list-style-type: none">• Images that look like old photographs or black-and-white movies can be taken.
TELE MACRO	<ul style="list-style-type: none">• Use this to take close-up (macro) shots of the subject.