

## Inserting an SD Card (GZ-HM350/GZ-HM330)

When a commercially available SD card is inserted, recordings can still be made to the card without stopping when the remaining recording time on the internal memory runs out.

- 1 Press the power button for more than 2 seconds to turn off this unit.

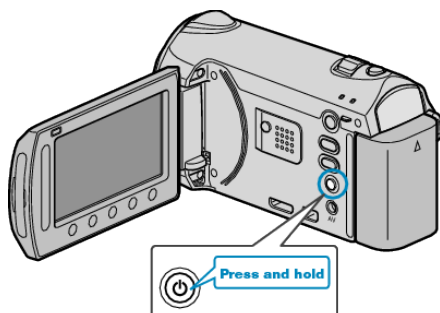

- 2 Open the card slot cover.

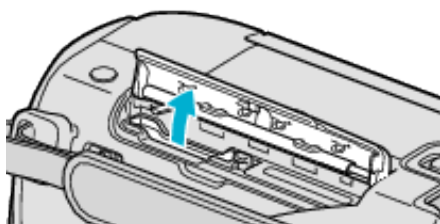

- 3 Insert an SD card.

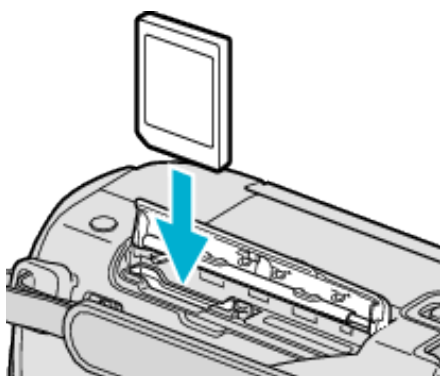

### CAUTION:

- Make sure not to insert the card in the wrong direction. It may cause damage to the unit and card.
- Turn off the power of this unit before inserting or removing a card.

### Memo:

- Recording switches automatically from one media to another and vice versa after the card or memory space in the selected media is full.
- To record to the card, it is necessary to adjust media settings. When no card is available, set media settings to "BUILT-IN MEMORY" for recording.
- To use cards that have been used on other devices, it is necessary to format (initialize) the card using "FORMAT SD CARD" from media settings.

## Removing the Card

Push the card inward once, then pull it out straight.

