

IMAGE QUALITY

Sets the image quality.

Setting	Details
FINE	Enables recording in high picture quality, but number of recordable images becomes lesser.
STANDARD	Enables recording in standard quality.

Displaying the Item

1 Select still image mode.

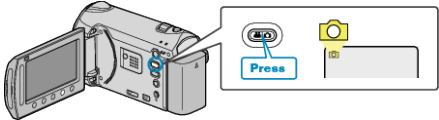

2 Touch to display the menu.

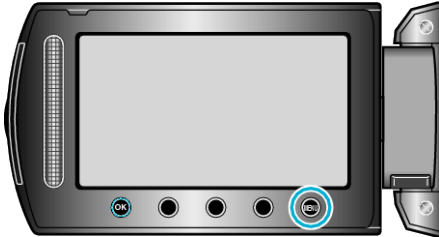

3 Select "IMAGE QUALITY" and touch .

