



SELF-TIMER

Use this when taking a group photo.

Setting	Details
OFF	Deactivates the self-timer.
2SEC	Starts recording 2 seconds after the SNAPSHOT button is pressed.
10SEC	Starts recording 10 seconds after the SNAPSHOT button is pressed. This setting is suitable for taking group photos.
FACE DE- TEC- TION	Detects faces when the SNAPSHOT button is pressed. Re- cording starts 3 seconds after the face of the photographer is detected. (1) Faces are detected  (2) Face of photographer is detected <p>Photographer</p> 

Displaying the Item

1 Select still image mode.

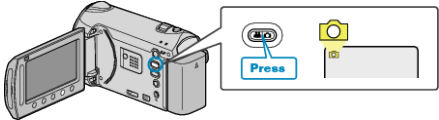

2 Touch  to display the menu.

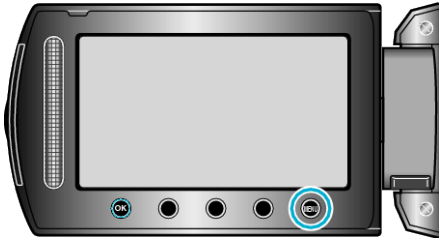

3 Select "SELF-TIMER" and touch .

