

Connecting via the HDMI Mini Connector

If you are using an HDTV, you can play back in HD quality by connecting to the HDMI terminal.

- We recommend using the Category 2 HDMI cable (High Speed cable).
- Refer also to the instruction manual of the TV in use.

1 Connect to the TV.

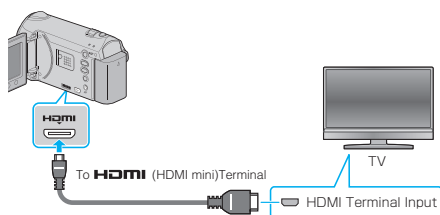

- Press and hold the power button for 2 seconds or more to turn off the power.

2 Connect the AC adapter to this unit.

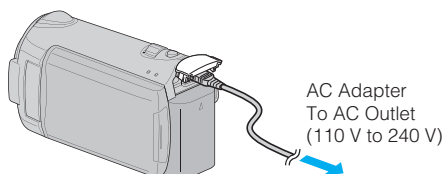

3 Press the external input button on the TV to switch to the input from this unit via the connected terminal.

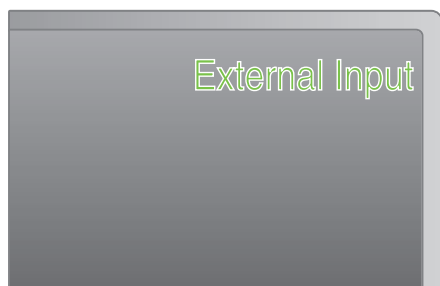

4 Play back a file.



Memo:

- To play back with date/time display, set "DISPLAY ON TV" in the connection settings menu to "ON". Set "ON-SCREEN DISPLAY" in the playback menu to "DISPLAY ALL" or "DISPLAY DATE ONLY".
- Change the settings in "HDMI OUTPUT" according to the connection.
- When connecting to the HDMI mini cable, the image or sound may not appear on the TV properly depending on the TV connected. In such cases, perform the following operations.
 - 1) Disconnect the HDMI mini cable and connect it again.
 - 2) Turn off and on this unit again.
- For questions about the TV or method of connection, contact your TV's manufacturer.